

AUDITORS CERTIFICATE

FILED FOR THE RECORD THIS _____ DAY OF _____ 2006 AT _____ M. IN BOOK _____ OF PLATS AT THE REQUEST OF THOMAS, DEAN & HOSKINS, INC.

SPOKANE COUNTY AUDITOR _____

FINAL PLAT OF PROGRESS PROPERTIES DEVELOPMENT SUB - 02 - 05 A PORTION OF THE SE 1/4 OF THE SE 1/4 OF SECTION 14, T25N, R44E, W.M. CITY OF SPOKANE VALLEY, WASHINGTON

BASIS OF BEARING

THE CENTERLINE BEARING OF PROGRESS ROAD TAKEN FROM THE FINAL PLAT OF SHERIDAN'S SUBDIVISION FILED BY CLARENCE E. SIMPSON IN FEBRUARY 1953.

SURVEYOR'S NOTES

- R1 = FINAL PLAT OF SHERIDAN'S SUBDIVISION, CLARENCE E. SIMPSON (1953)
R2 = RECORD OF SURVEY BOOK 86, PAGE 28
R3 = RECORD OF SURVEY BOOK 63, PAGE 31
R4 = RECORD OF SURVEY BOOK 90, PAGE 60
R5 = RECORD OF SURVEY BOOK 172, PAGE 1.

ACCURACY STATEMENT

SURVEY PERFORMED WITH NIKON DTM 450 TOTAL STATION USING FIELD TRAVERSE PROCEDURE AND CONFORMS TO WAC 332-130-090 AND RCW 58.09.

LEGEND

- SET 5/8" REBAR WITH YPC STAMPED "EMR PLS 42441"
○ SET COUNTY STANDARD MONUMENT CASE AND COVER
○ FOUND CORNER AS NOTED
⊕ SPOKANE COUNTY MONUMENT AS NOTED
① 135110 ADDRESS

CURVE DATA

Table with 5 columns: CURVE, DELTA, RADIUS, LENGTH, TAN, CHORD. Contains data for curves C1 through C13.

SURVEYOR'S CERTIFICATE

THIS MAP CORRECTLY REPRESENTS A SURVEY MADE BY ME OR UNDER MY DIRECTION IN CONFORMANCE WITH THE REQUIREMENTS OF THE SPOKANE COUNTY SUBDIVISION ORDINANCE

ERIC M. ROTH, P.L.S. WASHINGTON CERTIFICATE # 42441

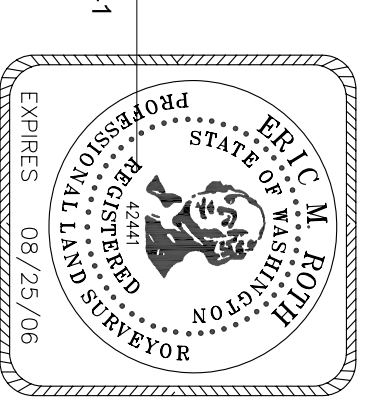

THOMAS, DEAN & HOSKINS, INC. ENGINEERING CONSULTANTS

303 EAST SECOND AVENUE SPOKANE, WASHINGTON 99202 (509) 622-2886, 622-2889 FAX

